

asa
TAILORMADE IN ITALY

VOLTA 50 PS

PLUG & SET

Tubular motor plug & play with wired electronic end limit switch with manual adjustment option of the end limits specific for:

rolling shutters with rigid links and stoppers

(not necessary when the motor is in manual setting mode).



asa
TAILORMADE IN ITALY

PROGRAMMING

Closely adhere to the procedure: UP or DOWN limit switch activation points can be programmed in any order.



**SHUNT 4 sec.
1 feedback**



ENTER MANUAL SETTING MODE

LIMIT SWITCH UP

1 Reach the top limit switch



2 SHUNT 2 sec. 1 feedback



3 Reach the bottom limit switch



4 SHUNT 2 sec. 2 feedback



End of programming

LIMIT SWITCH DOWN

- 1** Reach the bottom limit switch



- 2** SHUNT 2 sec. 1 feedback



- 3** Reach the top limit switch



- 4** SHUNT 2 sec. 2 feedback

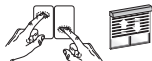

End of programming

RESET

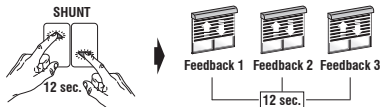

To modify the previously set limits:

- erase the memory (RESET).
- repeat limit switch adjustment.