

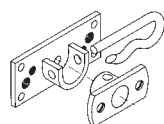

Motori tubolari
Tubular motors

ETR3 - ETR3-A - LP&S-R - ET-S - LP&P - LP&S - SUAW-EL - CD 45



2204145



NO ET-S

Staffa con perno rotondo a due posizioni
Bracket with two positions round pin and housing

CONF. 5 PZ / PACK. 5 PCS

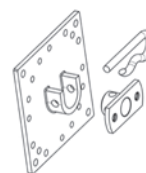

2204011



NO ET-S

Staffa 100x100 con sella per perno rotondo a due posizioni
100x100 bracket with two positions round pin

CONF. 5 PZ / PACK. 5 PCS



2204000



Piastrino perno quadrato
Square pin plate

CONF. 5 PZ / PACK. 5 PCS

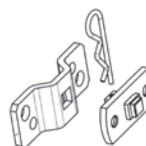

2204014



Staffa con perno quadrato completa di culla. Interasse 48/60 mm
Bracket with square pin center-to-center distance 48/60 mm

CONF. 5 PZ / PACK. 5 PCS



2204002



NO ET-S

Staffa con perno quadrato a "scatto" completa di culla. Interasse 48 mm e fori filettati (solo per motori con max 20 Nm)
Bracket with "click" square pin Threaded holes with center-to-center distance 48 mm (only for motors max 20 Nm)

CONF. 5 PZ / PACK. 5 PCS

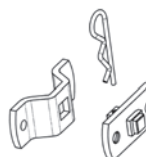

2204001



Staffa con perno quadrato completa di culla. Interasse 48 mm e fori filettati
Bracket with square pin threaded holes with center-to-center distance 48 mm

CONF. 5 PZ / PACK. 5 PCS

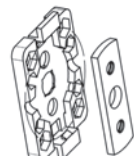

2204003



Staffa ad innesto "rapido". Ridottissime dimensioni di ingombro e facile applicazione (solo per motori con max 35 Nm)
Fast connection bracket minimum overall dimensions (only for motors max 35 Nm)

CONF. 5 PZ / PACK. 5 PCS



2204022



Staffa per supporti tipo "Torino" (aggiungere il perno quadrato per motori)
Bracket for support type "Torino" (match with square pin for motors)

CONF. 5 PZ / PACK. 5 PCS

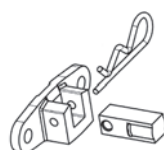

2204004



NO ET-S

Staffa con perno quadrato a scatto e culla per innesto del perno "dall'alto" (solo per motori con max 20 Nm)
Bracket with "open" housing for the click square pin (only for motors max 20 Nm)

CONF. 5 PZ / PACK. 5 PCS



2204025



NO ET-S

Staffa con perno quadrato a "scatto" completa di culla. Interasse 48/60 mm (solo per motori con max 20 Nm)
Bracket with "click" square pin Center-to-center distance 48/60 mm (only for motors max 20 Nm)

CONF. 5 PZ / PACK. 5 PCS



Motori tubolari Tubular motors

ETR3 - ETR3-A - LP&S-R - ET-S - LP&P - LP&S - SUAW-EL - CD 45



2204032



Staffa con perno quadrato con culla per innesto del perno "dall'alto" (solo per motori con max 30 Nm)
Bracket with "open" housing for the square pin. Clutch the pin from "above" (only for motors max 30 Nm)

CONF. 5 PZ / PACK. 5 PCS

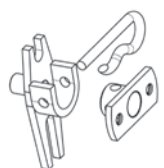

2204112



Staffa autocentrante per tende completa di sella e perno rotondo a due posizioni
Bracket for awnings with two positions round pin

CONF. 5 PZ / PACK. 5 PCS

NO ET-S

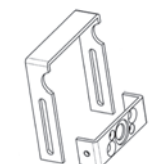

2204042



Staffa per mini cassonetti
Lunghezza 137 mm
Bracket for mini boxes
Length 137 mm

CONF. 5 PZ / PACK. 5 PCS

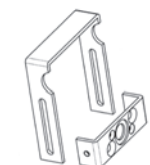

2204107



Staffa per mini cassonetti
Lunghezza 90 mm
Bracket for mini boxes
Length 90 mm

CONF. 5 PZ / PACK. 5 PCS

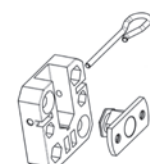

2204045



Staffa in zama con perno esagonale.
L'inserimento del perno avviene "dall'alto"
Metal bracket with hexagonal pin.
Clutch the pin from "above"

CONF. 5 PZ / PACK. 5 PCS

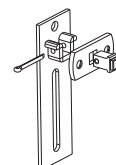

2204206



Staffa regolabile verticalmente con perno quadrato a due posizioni
Adjustable bracket with two positions square pin

CONF. 5 PZ / PACK. 5 PCS

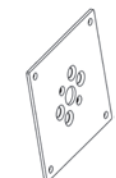

2204088



Staffa 100 x 100
100 x 100 bracket plate

CONF. 5 PZ / PACK. 5 PCS

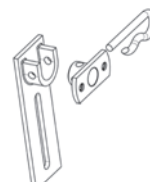

2204100



Staffa regolabile verticalmente con perno rotondo a due posizioni
Adjustable bracket with two positions round pin

CONF. 5 PZ / PACK. 5 PCS

NO ET-S

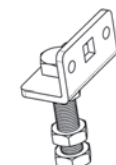

2204017



Staffa con perno Ø 10 per innesto diretto su murature già esistenti.
Ideale nelle ristrutturazioni.
Bracket Ø 10 threading pin for the direct clutch
ideal for the existing clamp

CONF. 5 PZ / PACK. 5 PCS

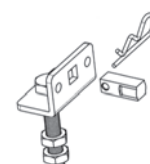

2204037



Staffa con perno Ø 10 per innesto diretto con perno quadrato a "scatto" e copiglia (solo per motori con max 20 Nm)
Bracket with Ø 10 "click" square pin and splint pin for the direct clutch (only for motors max 20 Nm)

CONF. 5 PZ / PACK. 5 PCS

NO ET-S

Motori tubolari
Tubular motors

ETR3 - ETR3-A - LP&S-R - ET-S - LP&P - LP&S - SUAW-EL - CD 45

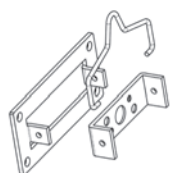

2204109



Staffa minimo ingombro
Minimum overall dimensions bracket

CONF. 5 PZ / PACK. 5 PCS

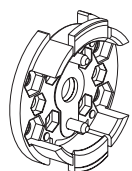

2204167



CLIPPO
Staffa clippabile per coppie alte
CLIPPO
Clipable bracket for high torques

NO ET-S

CONF. 5 PZ / PACK. 5 PCS

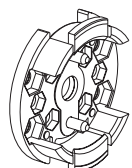

2204170



CLIPPO
Staffa clippabile per coppie basse (max 10 Nm)
CLIPPO
Clipable bracket for low torques (max 10 Nm)

CONF. 5 PZ / PACK. 5 PCS

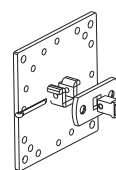

2204198



Staffa 100x100 per perno quadrato
100 x 100 bracket with two positions square pin

CONF. 5 PZ / PACK. 5 PCS

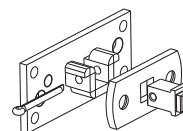

2204202



Staffa con culla per perno quadrato.
Interasse 48/60 mm
Bracket with two positions square pin
Centre to centre distance 48/60 mm

CONF. 5 PZ / PACK. 5 PCS